

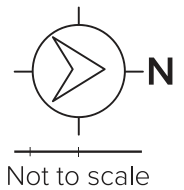

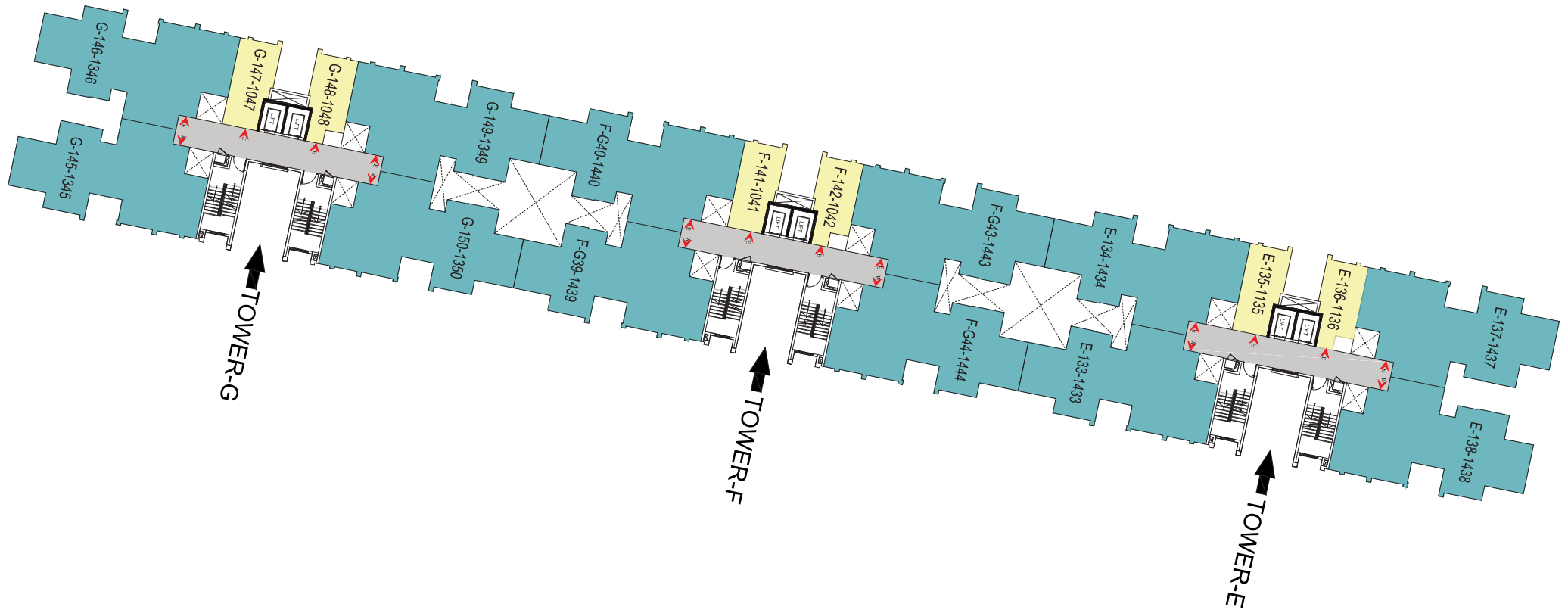





MASTER PLAN OF BRIGADE 7 GARDENS – ALL BLOCKS



NUMBERING PLAN OF BRIGADE 7 GARDENS – ALL BLOCKS



UNIT TYPE		
	TYPE-01	2 BEDROOMS + 2 TOILETS
	TYPE-02	3 BEDROOMS + 2 TOILETS
	TYPE-03	3 BEDROOMS + 2 TOILETS
	TYPE-04	2 BEDROOMS + 2 TOILETS
	TYPE-05	3 BEDROOMS + 2 TOILETS
	TYPE-06	2 BEDROOMS + 2 TOILETS
	TYPE-07	3 BEDROOMS + 3 TOILETS
	STUDIO	1 BEDROOM + 1 TOILET

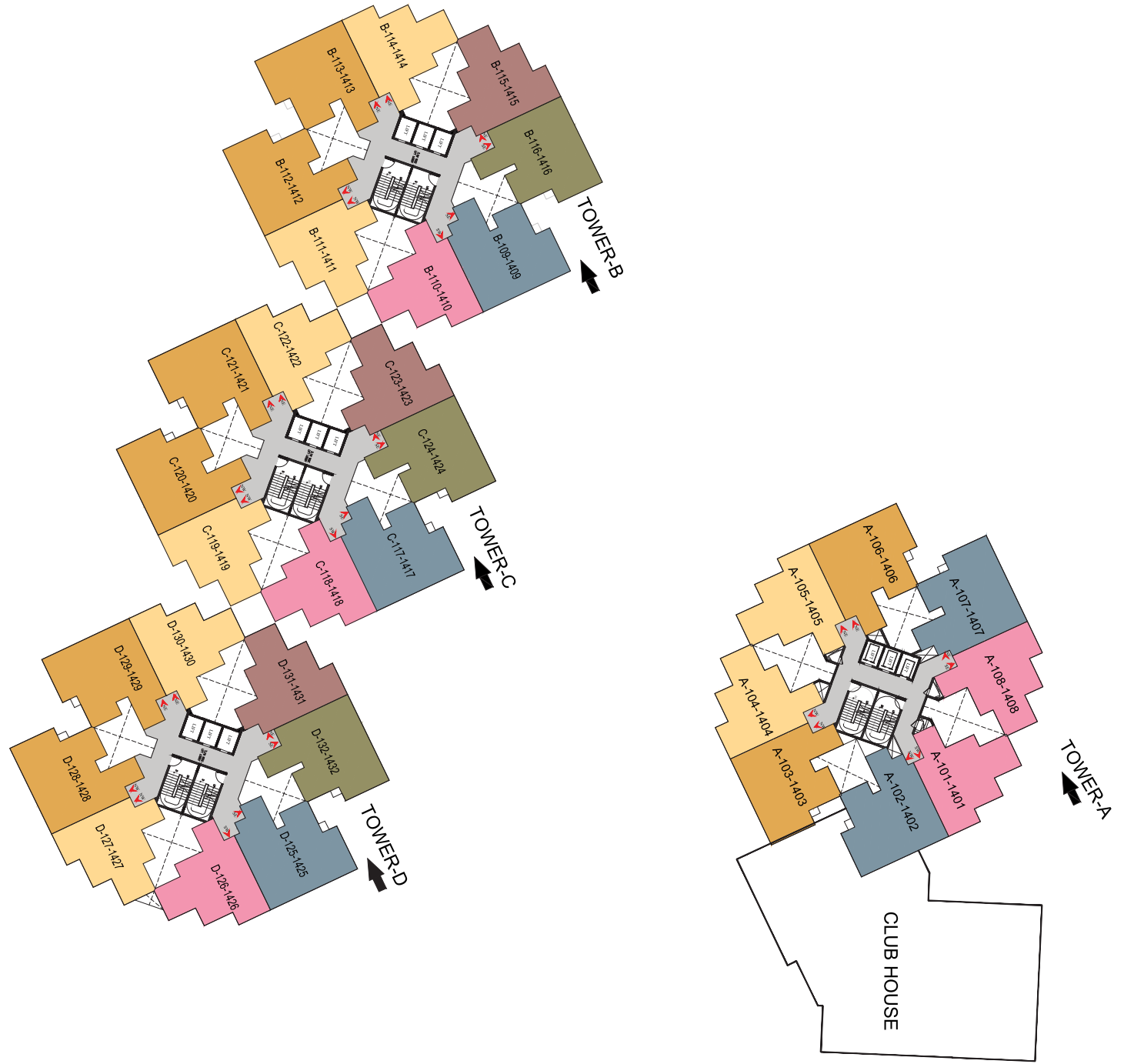

NUMBERING PLAN OF TOWERS B, C & D (G+14 Floors)

TOWER B

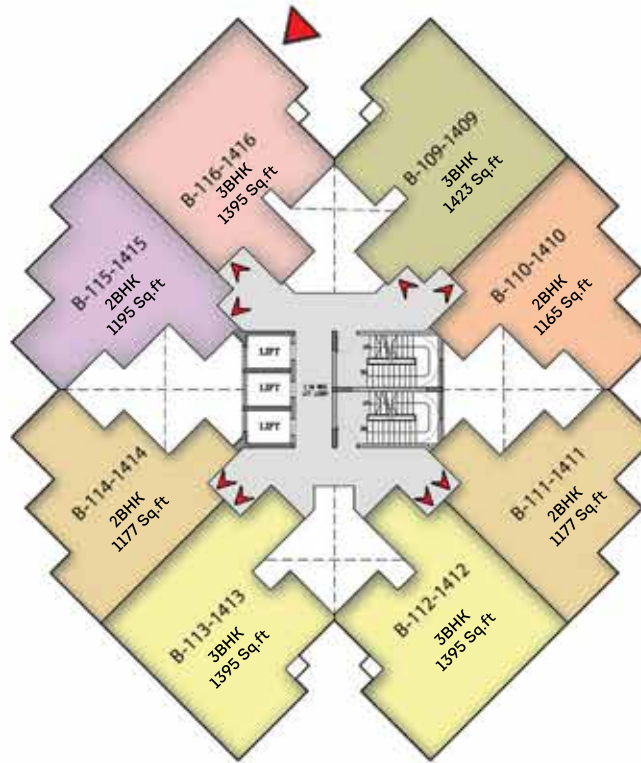

TOWER C

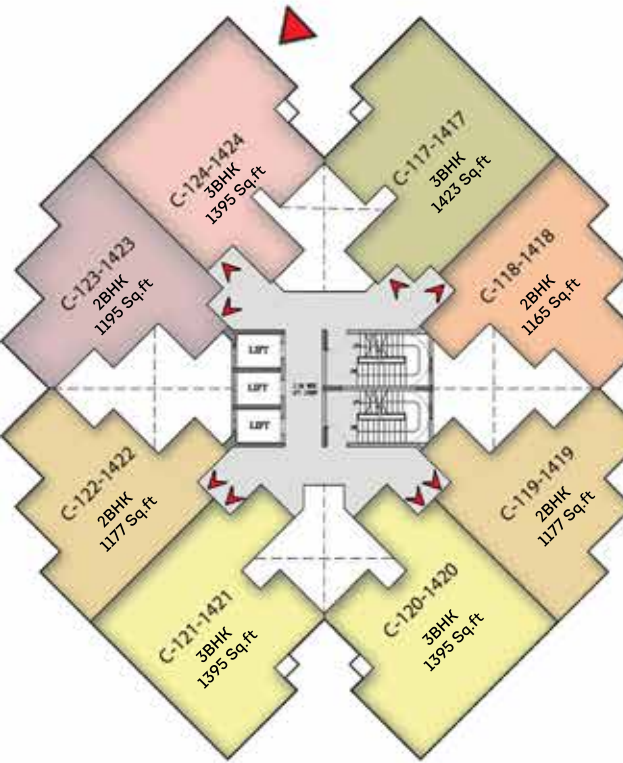

TOWER D

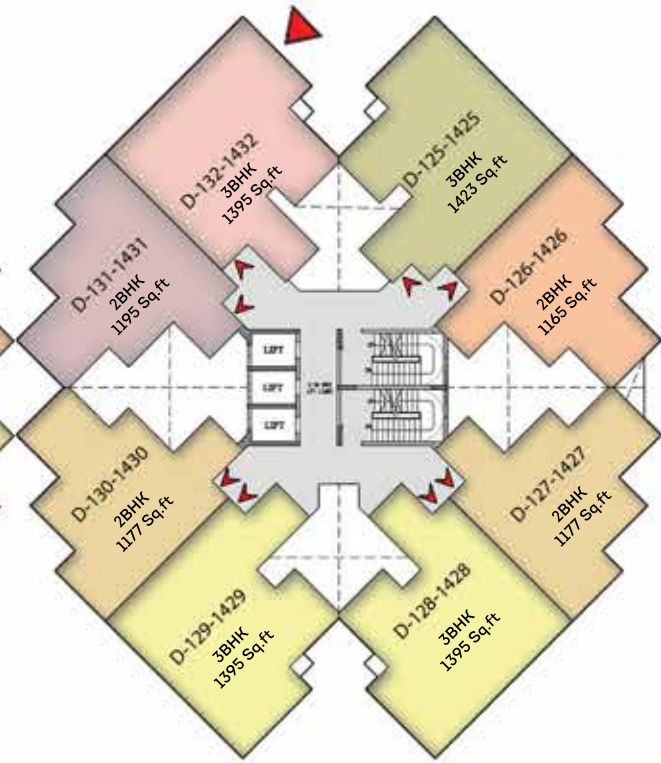

2BHK: 1165 Sq.ft (10, 18, 26)

2BHK: 1177 Sq.ft (14, 22, 30, 11, 19, 27)

2BHK: 1195 Sq.ft (15, 23, 31)

3BHK: 1395 Sq.ft (13, 16, 21, 23, 29, 31)

3BHK: 1423 Sq.ft (09, 12, 17, 20, 25, 28)

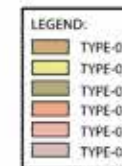

NUMBERING PLAN OF TOWERS E & F (G + 14 Floors) and G (G + 13 Floors)

TOWER E (G+14 Floors)

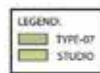
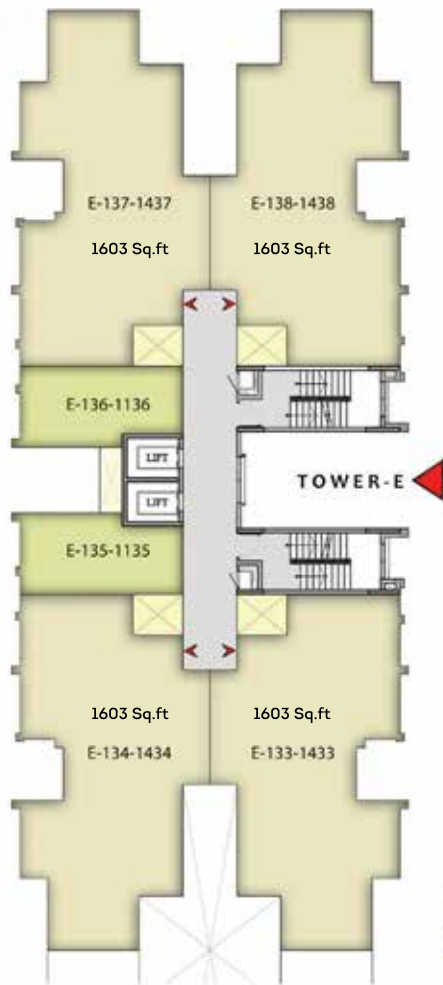

TOWER F (G+14 Floors)

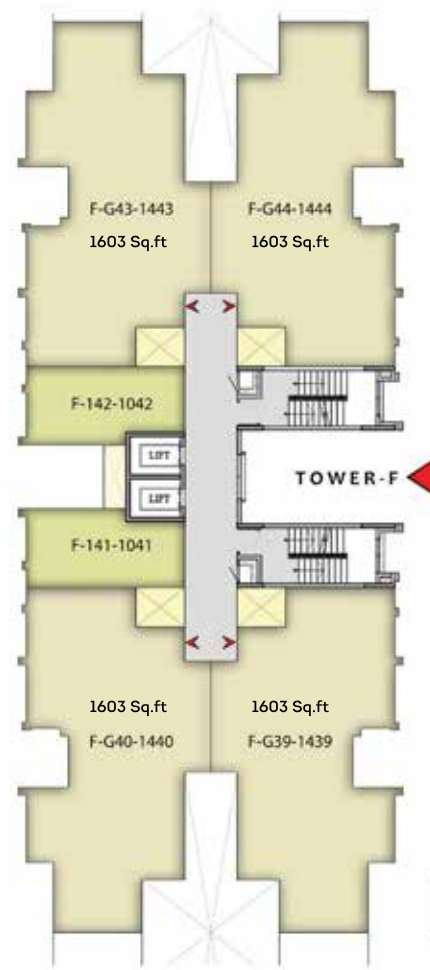

TOWER G (G+13 Floors)

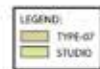
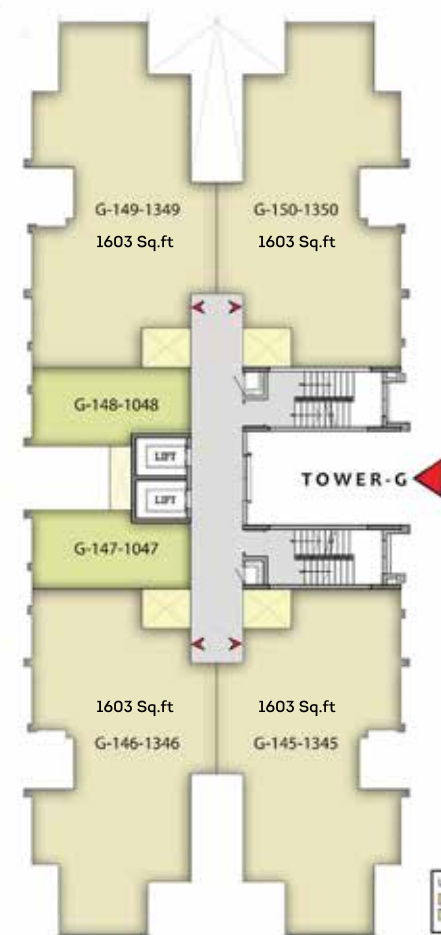

E Block: 1603 Sq.ft (37, 38, 33, 34)

Studio Apt: 371 Sq.ft (35, 36)

F Block: 1603 Sq.ft (39, 40, 43, 44)

Studio Apt: 371 Sq.ft (41, 42)

G Block: 1603 Sq.ft (45, 46, 49, 50)

Studio Apt: 371 Sq.ft (47, 48)

TYPICAL STUDIO UNIT

SUPER BUILT-UP AREA

371 sq.ft. / 34.46 sq.m.
(Shown below)

CARPET AREA

244.45 sq.ft. / 22.70 sq.m.
(Shown below)

SERIES

E Block: 35 & 36 | G Block: 47 & 48
F Block: 41 & 42



BLOCK PLAN

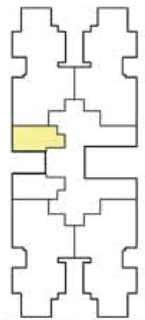

E, F, G

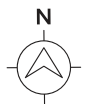

Not to scale

The information depicted herein viz., master plans, floor plans, furniture layout, fittings, illustrations, specifications, designs, dimensions, rendered views, colours, amenities and facilities etc., are subject to change without notifications as may be required by the relevant authorities or the developer's architect, and cannot form part of an offer or contract. Whilst every care is taken in providing this information, the Developer cannot be held liable for variations. All illustrations and pictures are artist's impression only. The information are subject to variations, additions, deletions, substitutions and modifications as may be recommended by the company's architect and/or the relevant approving authorities. The Developer is wholly exempt from any liability on account of any claim in this regard. (1 square metre = 10.764 square feet). E & OE.

Carpet area is defined as the net usable floor area of an apartment, excluding the area covered by the external walls, areas under services shafts, exclusive balcony or verandah area and exclusive open terrace area, but includes the area covered by the internal partition walls of the apartment.

TYPICAL UNIT PLAN

2-Bedroom 2-Toilet Unit

SUPER BUILT-UP AREA

1165 sq.ft. / 108.22sq.m.
(Shown below)

CARPET AREA

758.97 sq.ft. / 70.51 sq.m.
(Shown below)

SERIES

A Block: 1 & 8
B Block: 10

C Block: 18
D Block: 26



BLOCK PLAN

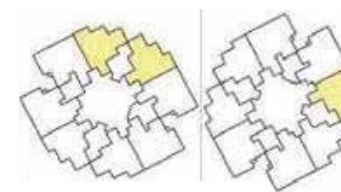

A

B, C, D

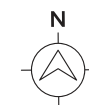

Not to scale

The information depicted herein viz., master plans, floor plans, furniture layout, fittings, illustrations, specifications, designs, dimensions, rendered views, colours, amenities and facilities etc., are subject to change without notifications as may be required by the relevant authorities or the developer's architect, and cannot form part of an offer or contract. Whilst every care is taken in providing this information, the Developer cannot be held liable for variations. All illustrations and pictures are artist's impression only. The information are subject to variations, additions, deletions, substitutions and modifications as may be recommended by the company's architect and/or the relevant approving authorities. The Developer is wholly exempt from any liability on account of any claim in this regard. (1 square metre = 10.764 square feet). E & OE.

Carpet area is defined as the net usable floor area of an apartment, excluding the area covered by the external walls, areas under services shafts, exclusive balcony or verandah area and exclusive open terrace area, but includes the area covered by the internal partition walls of the apartment.

TYPICAL UNIT PLAN

2-Bedroom 2-Toilet Unit

SUPER BUILT-UP AREA

1177 sq.ft. / 109.35 sq.m.
(Shown below)

CARPET AREA

764.14 sq.ft. / 70.9 sq.m.
(Shown below)

SERIES

A Block: 4 & 5 | C Block: 19 & 22
B Block: 11 & 14 | D Block: 27 & 30



BLOCK PLAN

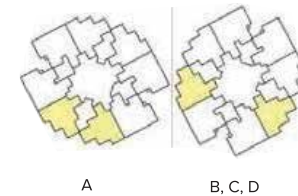

The information depicted herein viz., master plans, floor plans, furniture layout, fittings, illustrations, specifications, designs, dimensions, rendered views, colours, amenities and facilities etc., are subject to change without notifications as may be required by the relevant authorities or the developer's architect, and cannot form part of an offer or contract. Whilst every care is taken in providing this information, the Developer cannot be held liable for variations. All illustrations and pictures are artist's impression only. The information are subject to variations, additions, deletions, substitutions and modifications as may be recommended by the company's architect and/or the relevant approving authorities. The Developer is wholly exempt from any liability on account of any claim in this regard. (1 square metre = 10.764 square feet). E & OE.

Carpet area is defined as the net usable floor area of an apartment, excluding the area covered by the external walls, areas under services shafts, exclusive balcony or verandah area and exclusive open terrace area, but includes the area covered by the internal partition walls of the apartment.

TYPICAL UNIT PLAN

2-Bedroom 2-Toilet Unit

SUPER BUILT-UP AREA

1195 sq.ft. / 111.05 sq.m.
(Shown below)

CARPET AREA

775.33 sq.ft. / 72.03 sq.m.
(Shown below)

SERIES

B Block: 15
C Block: 23

D Block: 31



BLOCK PLAN



B, C, D

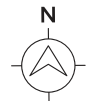

Not to scale

The information depicted herein viz., master plans, floor plans, furniture layout, fittings, illustrations, specifications, designs, dimensions, rendered views, colours, amenities and facilities etc., are subject to change without notifications as may be required by the relevant authorities or the developer's architect, and cannot form part of an offer or contract. Whilst every care is taken in providing this information, the Developer cannot be held liable for variations. All illustrations and pictures are artist's impression only. The information are subject to variations, additions, deletions, substitutions and modifications as may be recommended by the company's architect and/or the relevant approving authorities. The Developer is wholly exempt from any liability on account of any claim in this regard. (1 square metre = 10.764 square feet). E & OE.

Carpet area is defined as the net usable floor area of an apartment, excluding the area covered by the external walls, areas under services shafts, exclusive balcony or verandah area and exclusive open terrace area, but includes the area covered by the internal partition walls of the apartment.

TYPICAL UNIT PLAN

3-Bedroom 2-Toilet Unit

SUPER BUILT-UP AREA

1395 sq.ft. / 129.59 sq.m.
(Shown below)

CARPET AREA

922 sq.ft. / 85.63 sq.m.
(Shown below)

SERIES

A Block: 3 & 6
B Block: 12, 13 & 16
C Block: 20, 21
D Block: 28, 29



BLOCK PLAN

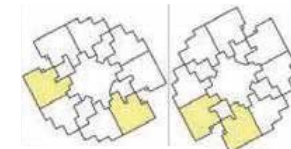

A

B, C, D

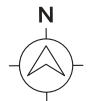

Not to scale

The information depicted herein viz., master plans, floor plans, furniture layout, fittings, illustrations, specifications, designs, dimensions, rendered views, colours, amenities and facilities etc., are subject to change without notifications as may be required by the relevant authorities or the developer's architect, and cannot form part of an offer or contract. Whilst every care is taken in providing this information, the Developer cannot be held liable for variations. All illustrations and pictures are artist's impression only. The information are subject to variations, additions, deletions, substitutions and modifications as may be recommended by the company's architect and/or the relevant approving authorities. The Developer is wholly exempt from any liability on account of any claim in this regard. (1 square metre = 10.764 square feet). E & OE.

Carpet area is defined as the net usable floor area of an apartment, excluding the area covered by the external walls, areas under services shafts, exclusive balcony or verandah area and exclusive open terrace area, but includes the area covered by the internal partition walls of the apartment.

TYPICAL UNIT PLAN

3-Bedroom 2-Toilet Unit

SUPER BUILT-UP AREA

1423 sq.ft. / 132.23 sq.m.
(Shown below)

CARPET AREA

942 sq.ft. / 87.56 sq.m.
(Shown below)

SERIES

A Block: 7
B Block: 9

C Block: 17
D Block: 25



BLOCK PLAN

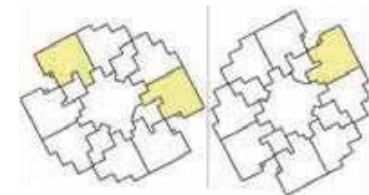

A

B, C, D

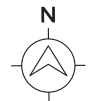

Not to scale

The information depicted herein viz., master plans, floor plans, furniture layout, fittings, illustrations, specifications, designs, dimensions, rendered views, colours, amenities and facilities etc., are subject to change without notifications as may be required by the relevant authorities or the developer's architect, and cannot form part of an offer or contract. Whilst every care is taken in providing this information, the Developer cannot be held liable for variations. All illustrations and pictures are artist's impression only. The information are subject to variations, additions, deletions, substitutions and modifications as may be recommended by the company's architect and/or the relevant approving authorities. The Developer is wholly exempt from any liability on account of any claim in this regard. (1 square metre = 10.764 square feet). E & OE.

Carpet area is defined as the net usable floor area of an apartment, excluding the area covered by the external walls, areas under services shafts, exclusive balcony or verandah area and exclusive open terrace area, but includes the area covered by the internal partition walls of the apartment.

TYPICAL UNIT PLAN

3-Bedroom 3-Toilet Unit

SUPER BUILT-UP AREA

1603 sq.ft. / 148.94 sq.m.
(Shown below)

CARPET AREA

1059.29 sq.ft. / 98.41 sq.m.
(Shown below)

SERIES

E Block: 33, 34, 37 & 38
F Block: 39, 40, 43 & 44
G Block: 45, 46, 49 & 50



BLOCK PLAN

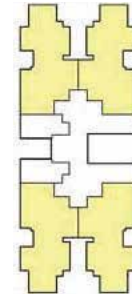

E, F, G

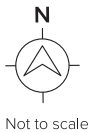

The information depicted herein viz., master plans, floor plans, furniture layout, fittings, illustrations, specifications, designs, dimensions, rendered views, colours, amenities and facilities etc., are subject to change without notifications as may be required by the relevant authorities or the developer's architect, and cannot form part of an offer or contract. Whilst every care is taken in providing this information, the Developer cannot be held liable for variations. All illustrations and pictures are artist's impression only. The information are subject to variations, additions, deletions, substitutions and modifications as may be recommended by the company's architect and/or the relevant approving authorities. The Developer is wholly exempt from any liability on account of any claim in this regard. (1 square metre = 10.764 square feet). E & OE.

Carpet area is defined as the net usable floor area of an apartment, excluding the area covered by the external walls, areas under services shafts, exclusive balcony or verandah area and exclusive open terrace area, but includes the area covered by the internal partition walls of the apartment.